

REVISONS		DATE	BY	APPV
AD	47	24MAR00	SU	DK
B		REVISE PER ECN 001B-0111-99		

△ MATERIAL: LIQUID CRYSTAL POLYMER, COLOR: NATURAL.

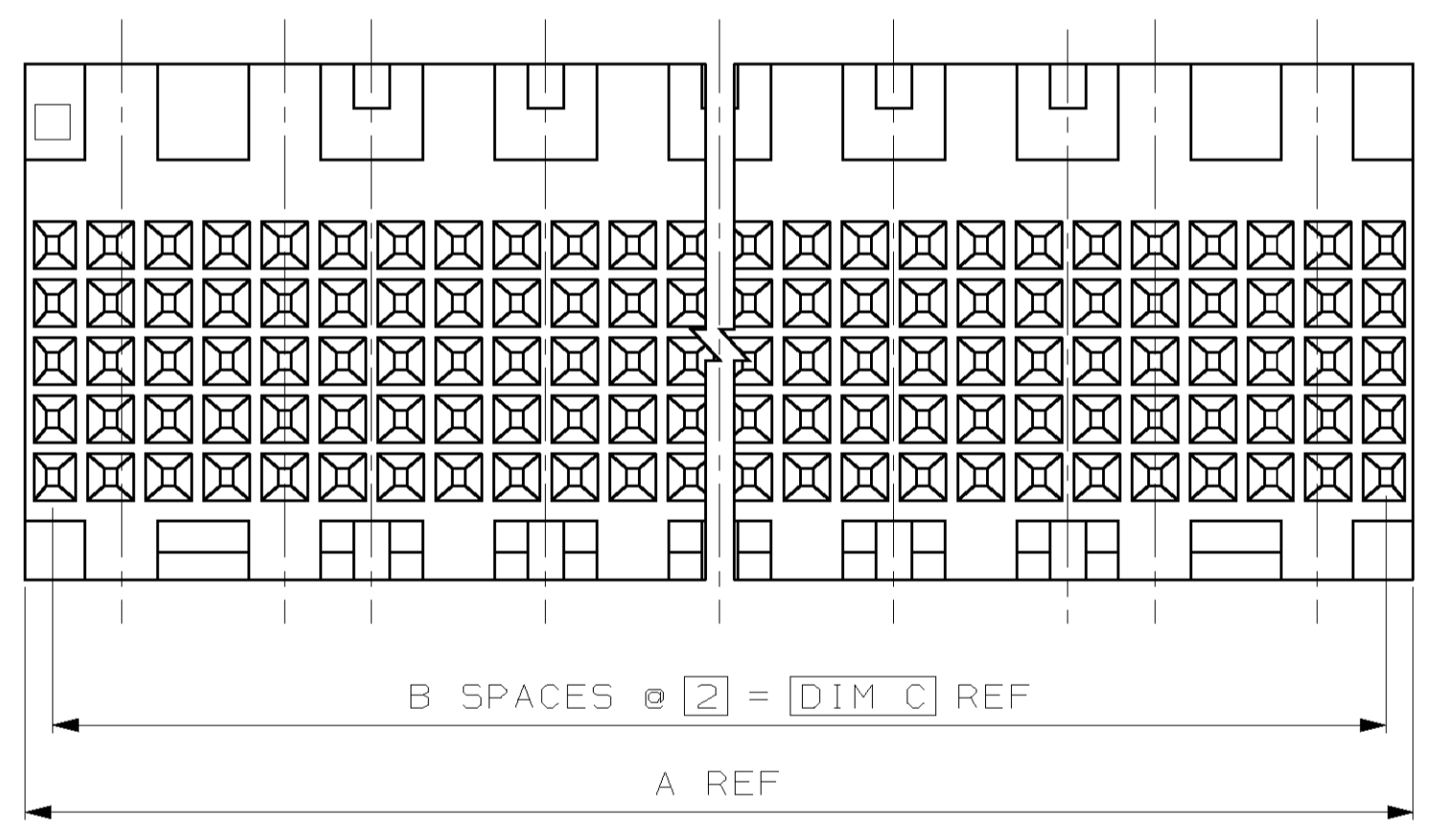
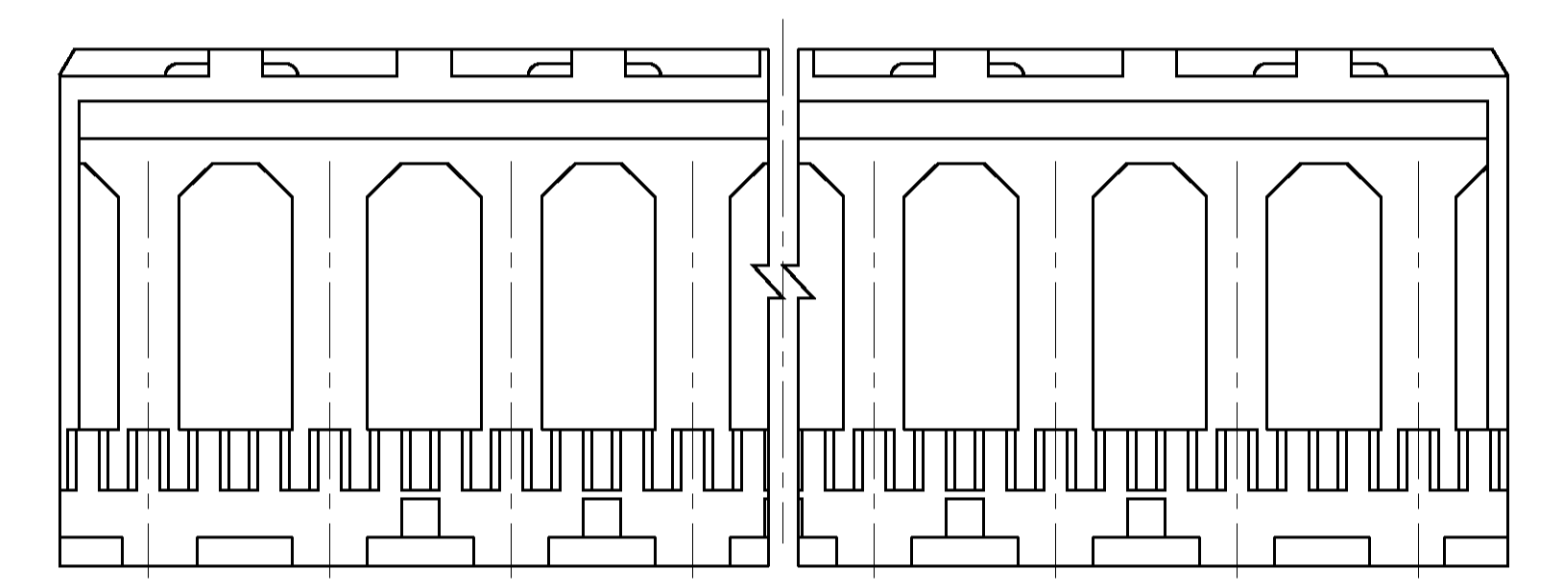
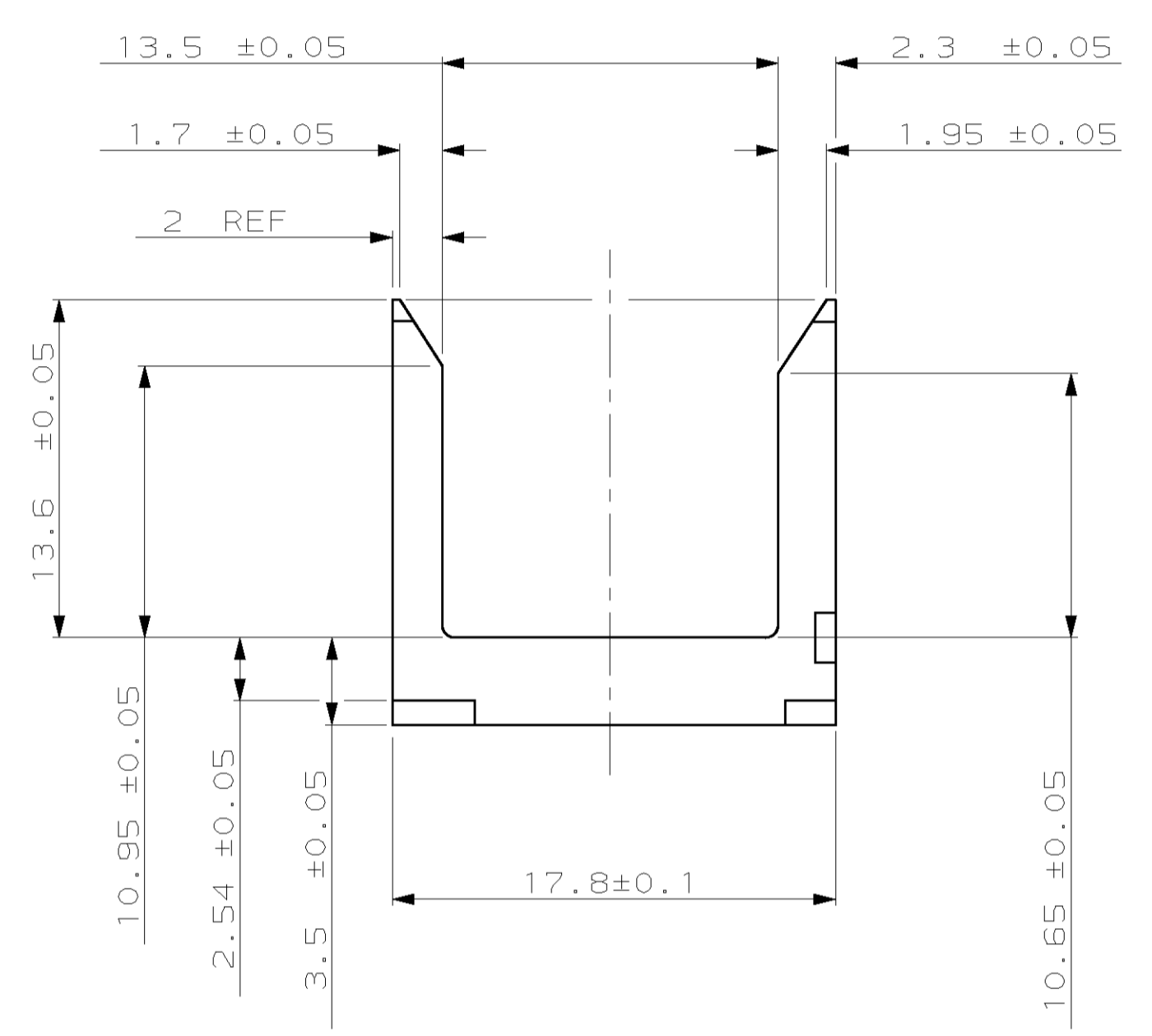
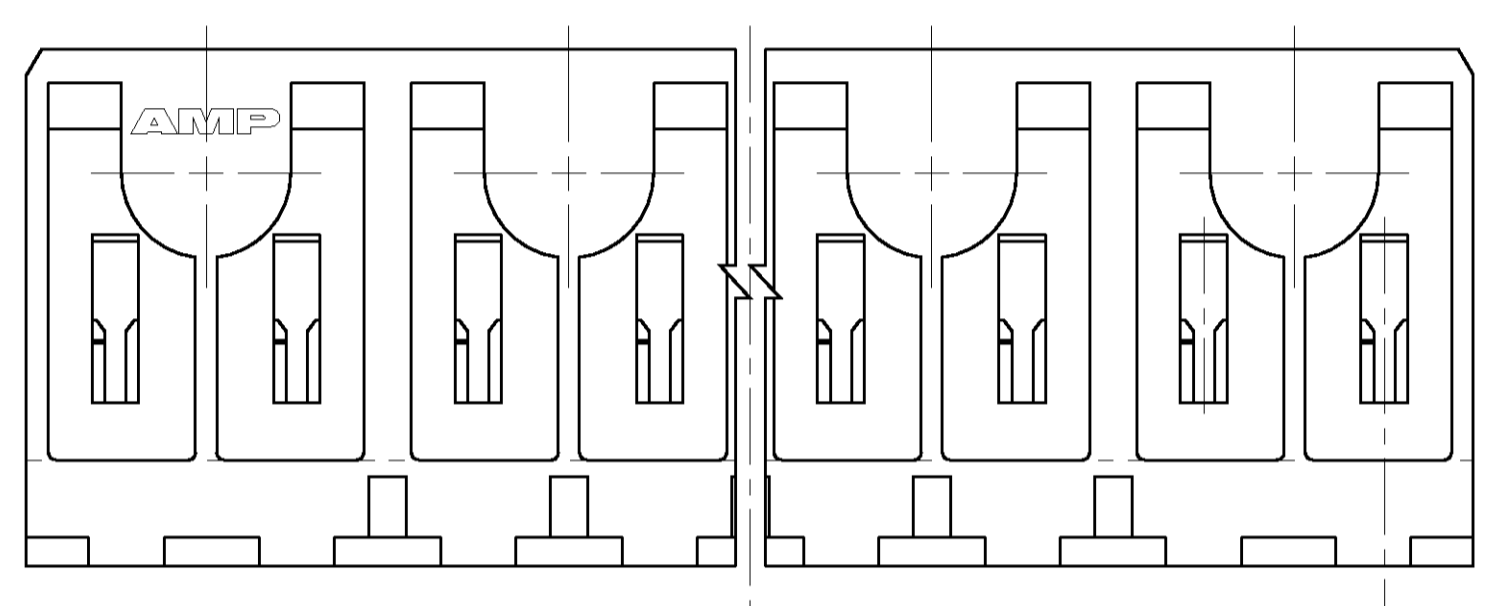
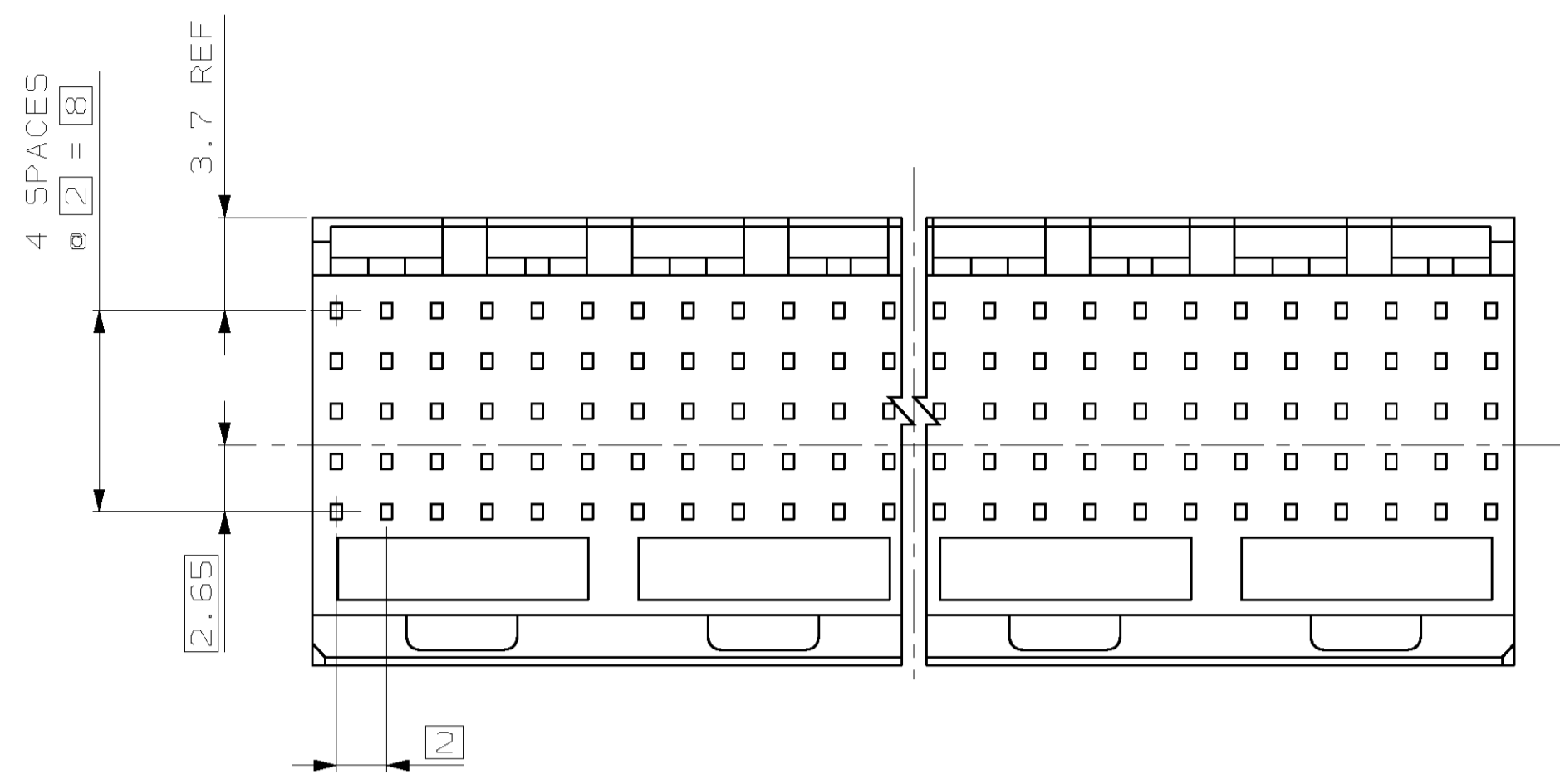

106	53	107.88	270	223041-9
94	47	95.88	240	223041-8
82	41	83.88	210	223041-7
70	35	71.88	180	223041-6
58	29	59.88	150	223041-5
46	23	47.88	120	223041-4
34	17	35.88	90	223041-3
22	11	23.88	60	223041-2
10	5	11.88	30	223041-1
C	B	A	NUMBER OF SIGNAL POSITIONS	PART NUMBER

<small>THIS DRAWING IS UNPUBLISHED. IT IS SUBJECT TO CHANGE AND THE CONTROLLING ENGINEERING ORGANIZATION SHALL BE CONTACTED FOR THE LATEST REVISION.</small>		DWN: R. BUCHHEISTER 08/JUL/96 CHK: D. BAECHTLE 08/JUL/96 APP'D: D. SINISI 08/JUL/96	12/DEC/95 <b>AMP</b> Incorporated Harrisburg, PA 17105-3608
DIMENSIONS: mm 	TOLERANCES UNLESS OTHERWISE SPECIFIED: 0 PLG ±.05 1 PLG ±.05 2 PLG ±.05 3 PLG ±.05 4 PLG ±.05 ANGLES ±.05	PRODUCT SPEC: - APPLICATION SPEC: - WEIGHT: -	SHROUD, SIGNAL, VERTICAL, 5 ROW, Z-PACK 2mm FB SIZE: A1 CAGE CODE: 00779 DRAWING NO: C=223041 SCALE: 4:1 SHEET: 1 OF 1 REV: B
MATERIAL: -		CUSTOMER DRAWING	